

# Washington's Great Work of Ages

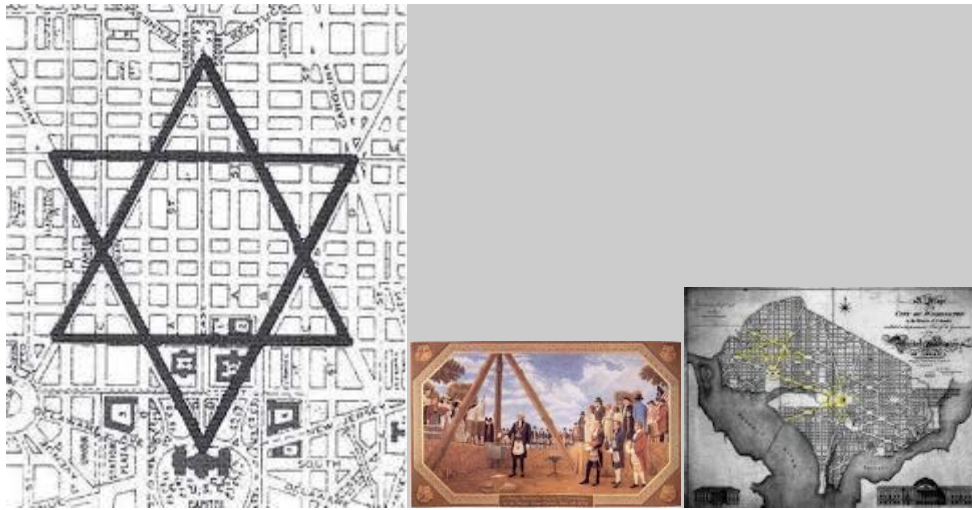

○



○



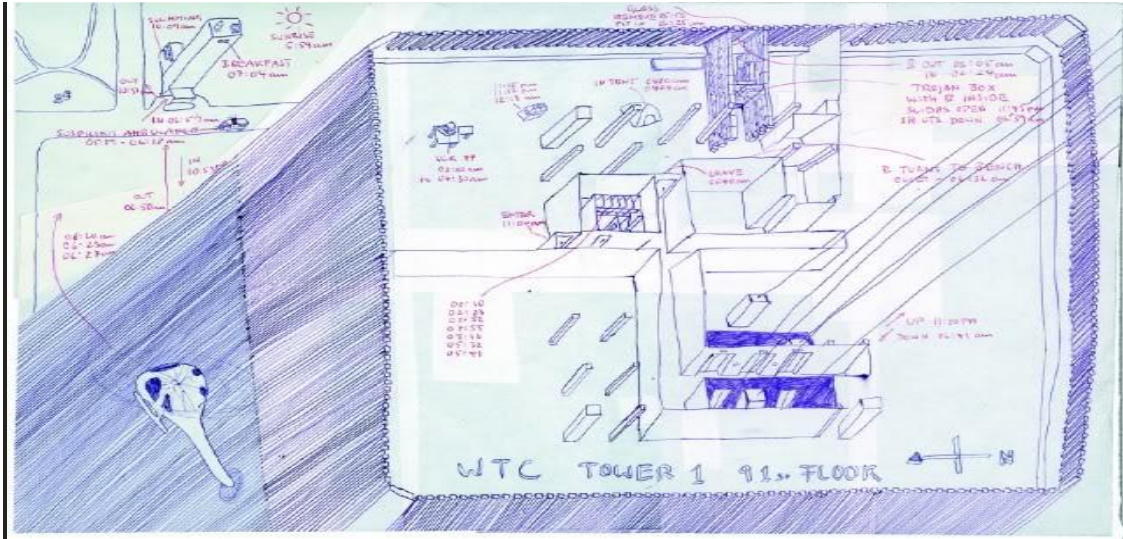

The Art Troupe Gelatin staged its exhibition on the 91<sup>st</sup> floor of Building 1 of the World Trade Center. They left the definitive signature of the future 9/11 event. Their art exhibition was staged weeks before 9/11. There are 19 floors from the 91<sup>st</sup> floor to the 110 floor. 119 is the emergency code for the Middle East. The art troupe consisted of Israelis. The exhibition and the math show that the World Trade Center was built according to a preconceived and pre-planned scheme that factored in its own planned destruction. They must have planned it years in advance. Why not the “secret destiny” of the United States referred to by FDR and Manley P. Hall suggests that the destiny of the U.S. was planned centuries in advance. The Washington street plan proves that the construction of the capital city of the USA was undertaken according to a long-term construction plan. Did that plan anticipate future events that were incorporated into its design?

A ceremony was held to commemorate the laying of the cornerstone for the U.S. Capitol the 200<sup>th</sup> Anniversary in 1993. Sen. Strong Thermit, a 33 degree Mason, presided over the ceremony. The Masons have laid the cornerstone for every major building in Washington D.C. George Washington laid the cornerstone for the Capitol Building and a bronze commemorative plaque exists inside the building stating the fact. The laying of the foundation stone ceremony involves the use of corn, oil and wine. “Corn is the symbol of plenty, wine the symbol involves the use of the symbol of refreshment and oil the symbol of joy and gladness.” They are portrayed as symbols of blessing. Dr. Robert Hieronimus claims there are as many as seven levels of meaning in Masonic symbolism. Corn is an important symbol in Masonry. In Hebrew, “Dagan” became the name of a Babylonian god. The Phoenicians worshipped him as “Dagan”. He was represented as the fish god, the god of corn. His son was known as Baal, who was called the Son of Dagan or the Son of Corn. His son was known as Baal, who was called the Son of Dagan or the Son of Corn. Yet in the Old Testament, the Israelites offer corn, oil and wine to Yahwey, the god of the Bible. As a result, YAHWEY is believed to have punished Israel for abusing the ritual and offering the sacrament to other gods: “She did not know that I have her corn, and wine and oil...which they prepared for BAAL.” Hosea 2:8 BAAL is depicted in ancient iconography as a strong masculine bearded figure. Similar iconography in stonework can be found on buildings in Washington D.C. Some images of the bearded persona carved in reliefs above arches and doorways of buildings have sheaves of corn lodged in the hair. According to legend, BAAL was slain by the god of death and taken to the underworld, but was resurrected or “awakened”. At

Hains Point in Washington, there is a bronze statue of what looks like a demon trying to emerge from the Earth. A bearded giant is depicted rising up out of the ground. The statue is called "The Awakening". Many believe that BAAL is the real god that Masons venerate and that offering of corn, oil and wine in foundation stone ceremonies is for the god BAAL. The Masonic god "Jubalon" is an amalgam of Jehovah, BAAL and On (Egyptian sun god). It is a password for gaining admission to the higher degrees. It is a satanic rite of passage unbeknownst to many of Masonry's initiates until they arrive in the higher degrees. Jehovah forbade the Israelites from using his name, declaring it blasphemous. BAAL was the demonic god of the Canaanites, and On was the Egyptian sun god. (Riddles in Stone) There are many passages in the Old Testament idolatry and the worship of other gods. Occult symbols reveal to those "who have eyes to see with and ears to hear with" and they conceal to the uninitiated. In Hosea, Chapter 2, the prophet imparts YAHWEY's profound displeasure on the subject of Israel's BAAL worship and idolatry:

8 For she did not know that I gave her corn, and wine, and oil, and multiplied her silver and gold, which they prepared for BAAL.

9 Therefore will I return, and take away my corn in the time thereof, and my wine in the season thereof, and will recover my wool and my flax given to cover her nakedness.

10 And now will I discover her lewdness in the sight of her lovers, and none shall deliver her out of my hand.

11 I will also cause all her mirth to cease, her feast days, her new moons, and her Sabbaths, and all her solemn feasts.

13 And I will visit upon her the days of Baalim, wherein she burned incense to them, and she decked herself with her earrings and her jewels, and she went after her lovers, and forgot me, saith the Lord.

14 Therefore, behold, I will allure her, and bring her into the wilderness, and speak comfortably unto her.

15 And I will give her her vineyards from thence, and the valley of Anchor for a door of hope: and she shall sing there, as in the days of her youth. And as in the day when she came up out of the Land of Egypt.

16 And it shall be at that day, saith the Lord, that thou shalt call me Ishi; and shall call me no more Baali.

17 For I shall take away the names of Baalim out of her mouth, and they shall no more be remembered by their name. (Hosea 2:8-17)

YAHWEY has made abundantly clear the fact that he is outraged with Israel for the god of her idolatry. The import of the passage is that YAHWEY gave the Israel the sacrament of corn, oil and wine for the purpose of consecration and anointing. However, Israel bastardized the consecration rites by carrying it out in the name of other gods, particularly BAAL, the demonic god of the Canaanites. Hosea announces that Israel has elicited the wrath of YAHWEY and that He has enacted a curse upon her for abusing the rites of consecration by honouring other gods:

13 Woe unto them! For they have fled from me: destruction unto them! because they have transgressed against me: though I have redeemed them, yet they have spoken lies against me.

14 And they have not cried unto me with their heart, when they howl upon their beds: they assembled themselves for corn and wine, and they rebelled against me.

15 Though I have bound and strengthened their arms, yet do they imagine mischief against me. (Hosea 7:13-15)

Hosea then links the craftsmen and masons to the abuse of the rites. This may be the historic link to the time when the craft guilds became corrupted by Satanism. Masonry today, therefore, like the Masonry of its forebears is corrupted by the worship of Satan and practice of Satanism and all of its accompanying black arts. The link is to be found in Hosea:

1 When Ephraim spake trembling, he exalted himself in Israel; but when he offended in Baal, he died.

2 And now they sin more and more, and have made them molten images of their silver, and idols according to their own understanding, all of it the work of the craftsmen: they say of them, let the men that sacrifice kiss the calves.

Corn, oil and wine are sacraments honouring the sun and the sun god. Satanism and sun god worship have converged so that their rites have comingled and become confused. This confusion is deliberate because the Satanists endeavour to conceal their designs by disguising themselves in the garb of another faith. This was true of the Khazars whose king converted to Judaism, ostensibly so as to protect his kingdom from being slaughtered by Christian and Saracen hordes. In truth, it is probable that the worship of demonic gods is precisely what rendered he and his people vulnerable, making the conversion to Judaism an effective disguise to don in the face of crusading armies, who would have regarded Jews as their respective parent religion and therefore no threat. It would also serve to offer the Khazarians a mask behind which they might conceal their true religion.

The priests of Ancient Egypt taught the peasants that the sun was god, while the priesthood held the subtler belief that the spirit that flowed through the sun was god. However, the high initiates of the priesthood above them knew that it was really the Dog Star Sirius that was the Supreme Being. Sirius was considered the brightest star in the heavens to the Egyptians, many times brighter than the sun. The Great Pyramid was built to synchronize with Sirius so the light of the star would shine into the Queen's Chamber in order to cast a beam upon an initiate during a ritual. When Sirius was in its ascendant in the "dog days" of summer, it was a time of drought and famine, so the star became associated with evil. Sacrifices were held to appease and gratify the principle of evil. In time, this became perverted so that evil became venerated and sacrifice was undertaken not to appease but to exalt and worship the god of evil.

The Declaration of Independence was signed when the sun was aligned with Sirius in July of 1776. When the Washington Monument cornerstone was laid in 1848, the sun had just passed over Sirius. Sirius would have been in the eastern sky rising over the Capitol Building during the ceremony. The monument was designed by Freemason architect Robert Mills. It was originally designed with a Roman-style colonnade around it and the original plan called for it to be erected

just south of the White House. It was moved because the ground was not firm enough to support such a structure. It was not in perfect alignment with the White House in the new location, but was in perfect north-south alignment with the Masonic House of the Temple, which began later. It took thirty years till the aluminum capstone was finally set in place in 1884. George Perkins Marsh, founder of the modern environmental movement, was responsible for the final design modifications. He was the US Foreign Minister to Italy. While there, he undertook detailed study of the many obelisks brought there from Egypt. Traditional Egyptian obelisks were raised to be ten times the base, so he reduced the height from 600 feet to 555 feet. He decided to discard Mill's original design and to build only the obelisk. A true obelisk is fashioned from one block of stone, but the Washington Monument is made up of many stones. It is supposed to represent *E Pluribus Unum*. The pyramidian at the top is composed of thirteen levels just like the Great Pyramid featured on the hind side of the American one dollar bill. The orientation of Masonic building structures toward the east places them in reference to the rising sun, but also the rising Sirius Star. Aleister Crowley belonged to the Lodge of the Silver Star, which is Sirius, which is at the heart of a lot of ceremonial magic. The 5-pointed star in Masonic Temples represents Sirius and the Pentacle thought by many to be a satanic symbol. "The Black Star" is an ancient Gnostic term for Sirius. The Black Star is a symbol prominently displayed as the symbol of the CIA. An upright pentacle star is said to represent the non-demonic branch of Freemasonry, while the downturned one represents the malevolent branch. Sirius rises in the east and is known as "the Eastern Star". It was identified with the dog god Anubis, who guarded the gates of death and was the protector of mysteries and as the guard of hell. But Sirius was also connected with the Egyptian goddess Isis. The appearance of Sirius preceded the annual flooding of the River Nile. This was the same time that Isis would give birth to Horus, the son of the sun god.

The recovery of the missing capstone symbolized the return of the Great Initiate, which obviously refers to the return of Christ. Albert Pike wrote, "The sun and moon...represent the two grand principles...the male and the female...both shed their light upon their offering, the Blazing Star, or Horus...." (Morals and Dogma, p.13,14)

The 105<sup>th</sup> Congress on Jan. 5, 2007 introduced House Resolution 33 to honour Freemasons for the contribution throughout American history. It acknowledges that the majority of those who signed the Declaration of Independence were Freemasons. They intended to found a Masonic Republic on the basis of Plato's model of centuries ago. Every socialist country has always called itself a Republic in order to legitimize itself. It was Plato who laid down the earliest known record of Ancient Atlantis. Francis Bacon later wrote the "New Atlantis", which was thought to be a blueprint for the New World. Bacon apparently believed that the American continent was the actual site of Ancient Atlantis, a belief held by many esoteric researchers to this day. Some ancient maps show that the east coast of America was actually the west coast of Atlantis.

Manley P. Hall is honoured as Masonry most revered philosopher. He founded the Philosophical Research Society in California, which began in 1934 and was dedicated to studying all the world's traditions. Much of Hall's research was funded by a Baroness, and much of it was dedicated to discovering what was behind the founding of America. Hall believed America has a secret destiny that was known to the secret societies of the ancient world. Hall has secretive relations with the White House under President Franklin D. Roosevelt. FDR sent men to microfiche many of the books in Hall's library. The Rosicrucian Nicholas Rourke was close to Hall and was a member of the Theosophical Society. He was said to be a spiritual mentor of Henry Wallace, the Secretary of the Treasury under FDR. Wallace was a 32 Degree Freemason

and FDR's vice-president. It was Rourke's influence that compelled FDR to place the Great seal of the US on the back of the one dollar bill. Today, a statue of Nicholas Rourke exists at the PRS Library. The New Deal of FDR is a euphemism for the New World Order or the New order of the Ages. FDR envisioned his administration as being responsible for creating a new World order out of the Depression. The principles of "democracy" were the main agenda of Freemasonry down through history known as "the Great Work" or "the Great Work of Ages". In "The Secret Destiny of America," Manly P. Hall wrote, "World democracy was the secret dream of the great classical philosophers....The brilliant plan of the Ancients has survived to our time...and it will continue to function until the great work is accomplished." (Secret Destiny of All Ages, p.15)

President Bush suggests the goal of the New World Order in his inaugural address in 2005: "when our founders declared a New World Order of the Ages, they were acting on an ancient hope that is meant to be fulfilled." However the ancient philosophers all acknowledged that a true democracy was only achievable in a society of perfected men. This is the essence of Hegel's concept of the "absolute Spirit". It is the occult promise of democracy reflective of America's seeming Christian roots? Why are there so many ancient pagan symbols adorning America's institutions and buildings? Why did the Founding Fathers declare themselves Christians and at the same time erect so many buildings dedicated to pagan gods and goddesses? Perhaps it is because prosecution was so rife in Christian Europe that great secrecy was required for self-preservation for these men who subscribed to ancient pagan beliefs. Rosicrucianism has exerted a profound influence on Freemasonry. The rose is said to be symbolic of secrecy and the occult, while the cross is said to symbolize Christianity. It is therefore thought to be the unity of the two. Charles Thompson was famous for his English translation of the Old and New Testament, but was also responsible for approving the occult design of the Great Seal. Thompson was closely associated with Peter Miller, a Rosicrucian adept and a member of the Ephitera Society based in Pennsylvania. The Ephitera Cloister is thought to be the first esoteric settlement in the New World. Benjamin Franklin asked Peter Miller to translate the Declaration of Independence into several European languages. The printing of these documents was done at Ephitera Cloister. Miller was connected to many of the Founding Fathers through the American Philosophical Society founded by Ben Franklin in 1743. Thomas Paine, Alexander Hamilton, Thomas Jefferson, the Marquis de Lafayette, George Washington, Charles Thompson and Peter Miller were all members. Charles Darwin and Thomas Edison would join in their day. It was modeled after Francis Bacon's "Invisible College" and the "Pagan Society". The Rosicrucians referred to themselves as the "invisible Brotherhood", so Rosicrucian Francis Bacon founded the "Invisible College". A pelican is seen feeding on the Great Seal for the State of Louisiana. It is found in a picture in Manly P. Hall's "The Secret Teachings of All Ages". The Temple Church in London is a Knight Templar Church. It contains many Rosy Crosses. The State Capital building of Louisiana features similar rose designs. Such reliefs are also found inside the old courtroom, and can be found throughout the Library of Congress. "Knowledge is power" was a maxim of Francis Bacon. His famous quote can be seen next to his statue in the Library of Congress. Pallas Athena was the patron goddess of Bacon and wore the mask of invisibility. She can be found decorating many paintings and decorative reliefs. A painter named Webber belonged to the salon de la Rose Croix designed many of the paintings in the Library of Congress. Dante was a Rosicrucian Grand Master and infused his writings with its themes. A statue of Dante holding his Divine Comedy can be found in Meridian Hill Park in Washington, located on the sacred 77<sup>th</sup> meridian upon which Washington D.C. is founded. There is one final emblem in the Library of

Congress that is symbolically profoundly significant. It features a crucifix with a black double-headed phoenix in the background. The Latin inscription reads: "Under the shadow of thy wings, protect us." (Psalm 17:8) Whose wings are being referred to in this cryptic allusion?

Enoch is the basis for the Greek Hermes, the Roman Mercury and the Egyptian Thoth. The Elizabethan sorcerer Sir John Dee was written by entities who passed on secrets of magic based on the Book of Enoch. The system is called Enochian Magic. Genesis 5:24 refers to Enoch. Hermes Trimegestis refers to "thrice greatest Hermes". Hermes and Hermetic tradition is said to have created the zodiac. Hermes is also responsible for the craft of creating cities which Hermes taught. "The Divine Pymander of Hermes Mercurius Trimegistus" was the progenitor of the concept "as above so below". The Square and Compass is a disguised Hexagram Star and symbolic as "above so below". The reflecting pools in Washington symbolize this reflecting of what is above in what is below. Pierre L'Enfant was the major designer of the Washington D.C. street plan. Many arguments took place between L'Enfant and Thomas Jefferson. L'Enfant was later fired but George Washington preserved his contribution by calling it the "L'Enfant Plan".

David Ovason wrote "The Secret Architecture of Our Nation's Capital". He argues that the real secret of Washington resides in Federal Triangle. There is a right angle triangle surrounding the constellation Virgo, which is reflected in the Washington street plan. It symbolizes the Pythagorean Theorem. The theorem states that the base of the right angle triangle squared and the perpendicular side of the right angle triangle squared are equal to the third side known as the hypotenuse. The Master mason candidate is asked to meditate on the 47<sup>th</sup> problem of Euclid, which is the 47<sup>th</sup> theorem of Pythagoras and it is the Pythagorean Theorem where the sum of squared hypotenuse is equal to the sum of the squares of the other two sides in a right triangle. The upright side symbolizes the male, while the base symbolizes the female and the hypotenuse the Divine Child. Federal Triangle, therefore, symbolizes the Egyptian Holy Trinity of Osiris (BAAL), Isis (Astarte/Ishtar), and Horus. The White House, Washington Monument and the Capitol Building are oriented to form a right angle triangle. The squared elements resemble the letter Y. The placement of Washington at the base of the Potomac River and the Eastern rivers form a Y shape. This is intended to harness the spiritual energies associated with Virgo. But for what purpose? Are the energies intended to bring forth the Divine Child. David Ovason refers to Pennsylvania Ave. as the spiritual center of Washington D.C. It is the hypotenuse of Federal Triangle. The Divine Child is supposed to be the New Age Messiah, the coming together of the cosmic masculine and feminine forces to produce synergy. Alchemy comes from the Arabic word meaning chemistry. It is about the transformation of the lower self to the higher self, or from base metal to gold, sometimes the chemical marriage or wedding. "The Chemical Wedding of Christian Rosenkreutz" is a book which explains that man, having lost his original Adamic state, is divided within himself. He regains his integral nature only when the two powers...are again reconciled with one another."

The Buchanan monument placed Buchanan, a Mason, between a male and female god and goddess as the hypotenuse, where the perfected man would be. Daniel Carter Beard founded the Boy Scouts of America. The Boy Scout Memorial on 15<sup>th</sup> St. between East Street and Constitutional Ave. depict a Boy Scout as the Divine offspring between the male god and female goddess. The Meade Memorial commemorates the victory of Gen. Meade in battle and suggests he was helped by a heavenly throng of gods and goddesses and an angelic host. Esotericists agree that one must be helped from above by drawing down spiritual forces to the Earth plane. In the 30<sup>th</sup> degree, Masons drink wine out of a human skull, which they are told embodies the blood

of Zoroaster, Buddha, Confucius, Jesus and all the venerable teachers of history, a form of Masonic transubstantiation.

The former Sovereign Grand Commander of the Ancient and Accepted Scottish Rite of Freemasonry, C. Fred Kleinkinecht, was pictured with Ronald Reagan when he was made an honorary 33<sup>rd</sup> Degree Mason. Kleinkinecht wrote the foreword to David Ovason's book. He writes "as above so below". These words, attributed to Hermes Trimegistus, lie at the heart of Western esoteric tradition.

Albert Pike was the personage who recommended stellar constellations be placed on the ceilings of Masonic Lodges. He was given the task of rewriting the Degree rituals for the Scottish Rite. He was the Sovereign Grand Commander of the Southern Jurisdiction based in Washington, the same office later held by Kleinkinecht. Pike declared that "the definition of Freemasonry is an advance toward the light". What light are the Masons referring to exactly? "Lucifer, strange and mysterious name to give to the spirit of darkness. Is it he who bears the light? Doubt it not!"

John Russel Pope, posing with the usual "hidden hand" of Freemasonry, is the designer of the Masonic House of the Temple, modelling it after the Mausoleum at Helicanarsus, one of the Seven Wonders of the Ancient World. The Temple is 13 blocks north of the White House and has 13 steps on its roof like the pyramid in the Great Seal. In the Library of Congress, it says, "The true Shekinah is man" or "Too low they build who build beneath the stars". The number 13 represents the will to go beyond the zodiac. In the cabbala, Shekinah represents the manifestation of God's glory.

Where are the earliest references to 13? In Genesis 14:4 it reads, "Twelve years they served Chedorlaomer, and in the thirteenth year, they rebelled." It signifies rebellion, apostasy and revolution. When America was made up of 13 colonies, its rebellion against England occurred. Benjamin Franklin was responsible for the design showing a serpent on the ceiling of the Capititol Building with the words, "Join or die", oddly echoed in George Bush's post-911 speech, "you're either with us or against us." Franklin proposed the phrase for the Great Seal: "Rebellion to Tyrants is Obedience to God". Franklin's serpent of rebellion is divided into 13 segments. The cornerstone of the White House was laid on October 13, 1792, October 13 being the date of the Templars dissolution in 1307.

The White House architect was an Irishman named James Hobin, who based his design on Langster House in Ireland, headquarters of the Irish parliament since 1922. Before that it was the first Masonic Temple in Ireland. Baron Karl von Hunt, Masonic author, says that some Templars went to Ireland before reorganizing to form their well known powerbase in Scotland. The knights had a foothold in Ireland since the 13<sup>th</sup> century through their banking operations. Langster House has connections to the Templars and used to be Killwinning Lodge No. 75 or the High Knights Templar of Ireland. James Hobbin was an Irish Freemason. October 13, 1792, when the cornerstone of the White House was laid, was the 485<sup>th</sup> anniversary of Black Friday when the Templars were dissolved as an order. The numbers  $4+8+5=17$ , and the cornerstone was laid 17 years after America's independence. Oct. 12, 1792 was the first celebration of Columbus Day in America.

Outside the House of the Temple, there are two Sphinxes, representing Wisdom and Power. The one with its eyes half closed is Wisdom, while the one representing Power has its eyes wide open and is looking heavenward. These two principles are said to embody Plato's concept of "the perfected man". The House of the Temple houses the remains of Albert Pike and there is an entire room dedicated to him. He lived to see the completion of the Capitol Building and the



Washington Monument. Some claim that Pike's radical brand of Freemasonry is the product of a tumultuous struggle that took place right after the revolution. Could this struggle have influenced many things including the design of Washington D.C. Weishaupt wrote a book titled "Pythagoras". His order, the Bavarian Illuminati was founded in 1776. Washington's design is based on Platonic solids and Pythagorean geometry. The Illuminati was founded by Freemason and Jesuit Weishaupt. Its purported goals were to achieve the separation of church and state, the imposition of controls on the power of the state, and the emancipation of women. It they were against the order of monarchs, then the date for the founding of America, the foundation of the Bavarian Illuminati, becomes important because they share the same ideals. Some believe Weishaupt's order was disbanded after being outlawed by the Bavarian government in 1785, creating its demise in 1786.

Some point to a letter written by George Washington in Oct. 24, 1798 for evidence of Illuminati influence in America. Writing to Rev. G.W. Snyder, Washington acknowledged the presence of Illuminati in America. Snyder had sent Washington "Proofs of a Conspiracy against all the Religions and Governments of Europe" by John Robinson. Washington wrote, "It was not my intention to doubt that the doctrines of the Illuminati and the Principles of Jacobinism had not spread in the United States. On the contrary, no one is more truly satisfied of this fact than I am." (The George Washington Papers at the Library of Congress, George Washington to George Washington Snyder, Oct. 24, 1789.

President Bush said in his inaugural address, Jan. 2005, "By our effort, we have lit the fire as well, a fire in the minds of men. It warms those who feel its power. It burns those who fight its progress, and one day this untamed fire of freedom will reach the darkest corner of our world." Interesting that James J. Billington, author of "Fire in the Minds of Men," was photographed with Laura Bush at the Library of Congress. His book title seems to have inspired Bush's speech. He argued in his book that it was the Illuminati that put the fire in the minds of men and inspired them to change the world. Like Obama, Bush believes there are different religions and different routes to finding God and going to heaven. His beliefs adhere more to Ecumenicalism than Christianity.

The Jacobins were a front name for the Illuminati. It was the Jacobin, Citizen Genet, who incited the Whisky Rebellion in 1794 in America as the French Ambassador. The Phrygian red cap was a symbol of the Revolution and was often worn by rebels or carried on a long staff. It is a prominent democratic symbol of the Library of Congress and is featured in other more revolutionary iconography. It can be traced back to Rome, where it was worn by slaves who had gained their freedom. It was worn by the dying god Mithras who was later resurrected. It was also worn by Ganymede. He was later given a place in the heavens by Zeus, where he became the constellation Aquarius.

Daniel was called "Rob Mag" meaning "Chief of the Magi". He resided in Persia during the reign of Nebuchadnezzar. An angel appeared to Daniel and gave him a timeline of when to expect the King of Israel. Many scholars believe the Magi from Persia were following the prophecies of Daniel. However, Masons believe the Magi were Zoroastrians who followed the Eastern Star, Sirius, to the birthplace of the Lord. Zoroaster means "radiant one" and referred to the bright halo around the prophet's head.

Eliphas Levi, the 19<sup>th</sup> century occultist, argued that the pentagram with one point up was a positive symbol, while the same symbol with the single point directed downward was malevolent. His writings inspired Blavatsky, Manly P. Hall, Albert Pike, and Aleister Crowley. Eliphas Levi's concept of the Pentagram was likely the influence of Henricus Cornelius Agrippa.

He published “Three Books of Occult Philosophy” in 1509. He is mentioned in Mary Shelley’s *Frankenstein* and the Harry Potter series. Today his works are published under the title “Foundation of Western Occultism” In his book, he features an inverted Pentagram and calls it “The Pentagram of Pythagoras”. According to Pythagoras, the inverted Pentagram symbolized “Tartarus”, one of the Greek words for Hell. Dante believed the descent into Hell would instruct the initiate and lead him to paradise.

Apologists for the street plan designers argue that the Pentagram in Washington found in the alignment of streets near the White House is incomplete or unfinished, but the “unfinished pentagram” has a place in the occult. Manley P. Hall writes in “The Secret Teachings of All Ages,” that “The pentagram is used extensively in black magic....The star may be broken at one point by not permitting the converging lines to touch...It may be inverted by having one point down and two up. When used in black magic, the pentagram is called the sign of the “cloven hoof”, or the footprint of the Devil.” (Secret Teachings, p.CIV) Goethe’s play *Faust* mentions “the unfinished pentagram” first published in 1890. The reference occurs in a scene between Faust and Mephistopheles:

Mephistopheles: Let me go up! I cannot go away! A little hindrance bids me stay.

Faust: The pentagram? That’s in your way? You son of Hell, explain to me, if that stays you, how come you in today?

Mehistopheles: Observe it closely. It is not well made. One angle on the other side of it, is just a little open, as you see.

*Faust* was published in 1890 and Pierre L’Enfant drew the initiate plan for the street map of Washington in 1791 and 1792. This might seem like coincidence except for the fact that Goethe was a Freemason and a prominent member of the Illuminati like L’Enfant. Michael Baigent points out that Goethe himself was a Faustian figure, an adjunct of his own hermetic quest. Could the unfinished pentagram in Washington have something to do with “as above so below”? David Oveson regards Washington as the “City of the Stars”. The “unfinished pentagram” design is actually reflected in the unfinished pentagram featured in Venus’ transits. Venus has a lot of retrograde motions because it’s between us and the sun. The Venus transits take eight years to complete. The five-petal flower is depicted throughout Washington and is an expression of Venus. The Pentagram Building references it as well.

The Golden Dawn saw the pentagram as a symbol of the “perfected man”. Eliphas levi believed the angels aspired to be men because the perfect man was above even the angels. The National Archives Building in Washington is surrounded by 72 columns. The average heart beats 72 times per minute. The sun drops back against the zodiac every 72 years. The pyramid on the back of the U.S. one dollar bill contains a pyramid 72 mason block stones.  $7+2=9$ , which is the number of finality, and 9 is a reversed 6, which is said to be the number of the “perfect man”. So it is hardly an accident that that an authority male figure should be found on the building overlooking Pennsylvania Ave., the hypotenuse of Federal Triangle adorned with 6 stars above his head. Beneath him on the ground are a male and female god and goddess with the “perfected man” in between. The figure above Pennsylvania Ave. looking down is called “Destiny”. Manley P. Hall spoke of “America’s assignment with destiny”, while FDR spoke of “America’s rendezvous with destiny”/ Is this the Masonic Christ? In New York, at the Cathedral Church of St. John the Divine, there is a Zoroastrian-looking cap with rays of light emitting from behind

him. Is the Christ of the New Age? Many believe such a figure is about to take his place on the world stage. Benjamin Creme, who he calls this figure “Matraya”, is standing by and is about to appear according to Creme. May 14, 1982 was the date of Creme’s first Matraya announcement. May 14 is also the birth date of the modern state of Israel. (Riddles in Stone)

There has been much written and discussed about Dec. 21, 2012. It is the winter solstice and hearkens back to the holidays of the pagan sun cults represented by the Babylonian trinity Nimrod, Simiramis and Tammuz and their Egyptian counterparts Osiris, Isis and Horus. After the Luciferians took over the Northern Kingdom of Egypt, following the influx of refugees from Land of Canaan known as the Hebiru or “Shepherd Kings,” the monotheistic religion of the Pharaoh Akhenaton came into being, which venerated the god of this world or Lucifer. The new religion and the older pagan cult then fused to produce the hybrid we know it as today and to which the elite Satanic cabal known as the Illuminati continue to subscribe. In light of this, December 21, 2012 – a date that will live in infamy because the world population has been brainwashed to welcome that date as one of great significance – is in fact a date with Lucifer. December 21 let us remember is the date that the sun god dies and goes to a dark place for three days until he is raised by the moon goddess three days later in a necromancy ceremony conceived to raise her consort from the dead. Thus, the date itself symbolizes the resurrection of the sun god, who is actually Lucifer since the cult of the sun god and the cult of Lucifer were actually fused in Egypt at the time of the Middle Kingdom. What this suggests is the rebirth of Lucifer, who will assume the world throne at the resurrected Temple in Jerusalem on December 21, 2012.

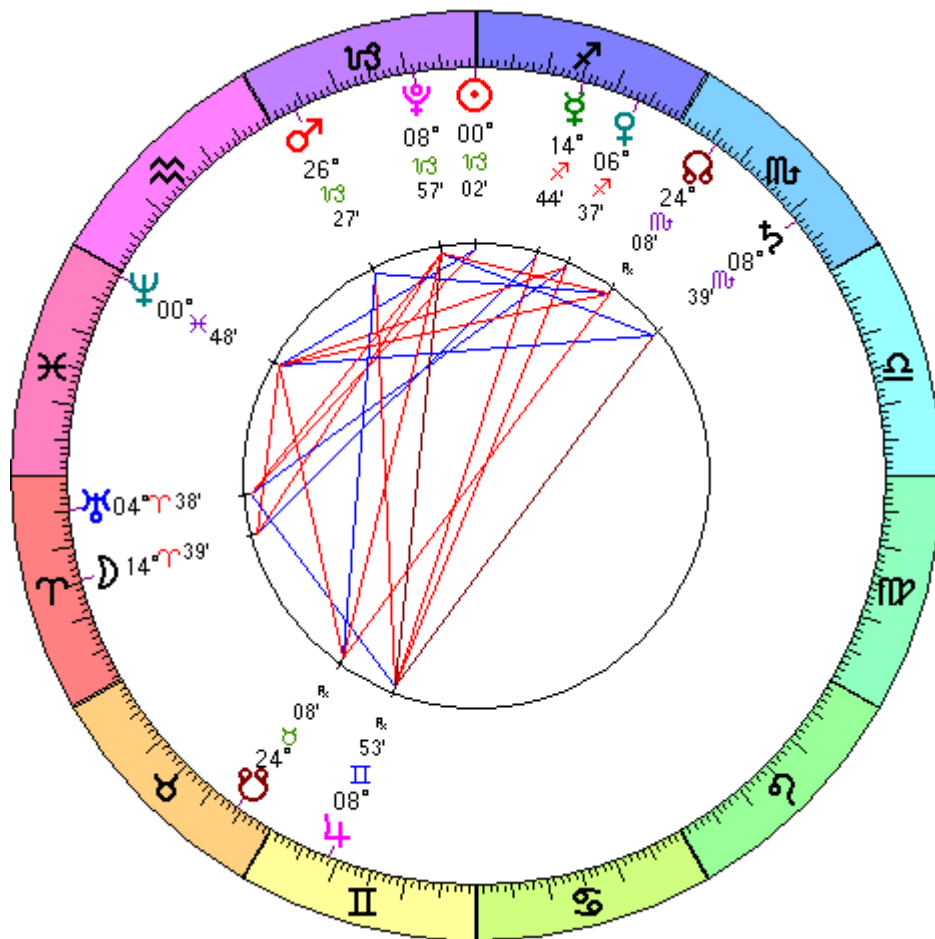

Astrological chart for December 21, 2012

To understanding the above chart for December 21, 2012, it is necessary to offer some background on the concept of sacred geometry and the occult significance of the geometric shapes found within this uniquely singular chart. The concentration of planetary rulerships in the first three houses and the last five houses of the chart creates a semi-circle of planetary influence that is immediately noticeable and discernible. This produces a matrix of lines based on trines, squares, and oppositions that produce obvious and significant geometric forms. The sacred geometry produced from these matrices is of such occult significance that it cannot be dismissed, especially in light of the date December 21, 2012, and what it actually commemorates. Present within the above chart is a perfected pyramid factoring in the Golden Mean or Pi ratio.

To offer some background to our study of sacred geometry, let us begin by going back to the dawn of civilization, where we see a figure emerging from the mist of history known as Enoch, first referred to in Genesis 5:24. Enoch is the basis for the Greek Hermes (Mercury to the Romans) and the Egyptian Thoth. The system is called Enochian magic. Hermes Trimegistus means “Thrice Greatest Hermes”. Hermes and Hermetic tradition is said to have created the zodiac. Hermetic tradition is also responsible for the craft of creating cities, which Hermes taught. “The Divine Pymander of Hermes Mercurius Trimegistus” introduced the concept of “As above So Below”. The Square and Compass is a disguised Hexagram Star and is symbolic of

“As above So Below”. The reflecting pools in Washington D.C. symbolize this reflecting of what is above in what is below.

David Ovason argues in “The Secret Architecture of Our Nation’s Capital,” that the real secret of Washington lies in Federal Triangle. There is a right angle triangle surrounding the constellation Virgo reflected in the Washington street plan. This is significant since the plan to usher in the Antichrist beings in mid-September 2009 when a stellium of planets comprised of Mercury, the Sun, Saturn and the Moon all appear in the 10<sup>th</sup> House relating to the public, conveying a strong commitment in terms of governance over health. This health initiative will be used to weaken the resistance of the people and to make them more susceptible to the influence of the Antichrist when he emerges on the world stage in 2012 represented as a Savior figure and the instrument of our planetary salvation.

Let us not forget that the right angle triangle is the geometric representation of the Pythagorean theorem. The theorem states that the base of the right angle triangle squared and the perpendicular side of a right angle triangle squared are equal to the third side known as the hypotenuse. The Master Mason candidate of Freemasonry is asked to meditate on the 47<sup>th</sup> problem of Euclid, which is the 47<sup>th</sup> theorem of Pythagoras, which also states that the sum of the squared hypotenuse is equal to the sum the squares of the other two sides in a right angle triangle. In occult circles, the upright side symbolizes the male, the base symbolizes the female and the hypotenuse symbolized the Divine Child. (Riddle in Stone) The Divine Child translates as the son of the sun god Tammuz/Horus, the product of the union of the sun god and his consort the moon goddess, but because of the fusing of the old sun god cults with the newer Lucifer cult, Osiris = Lucifer and the Divine Child Horus = the Antichrist.

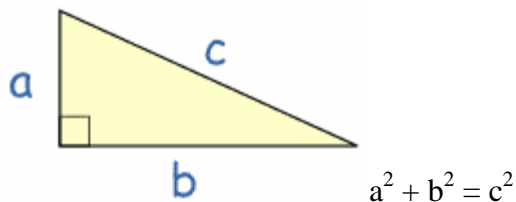

The White House, Washington Monument and the Capital Building all line up as a right angle triangle. The occultists intended for this street plan to draw on the spiritual energies of Virgo. Are the energies intended to bring forth the Divine Child? David Ovason refers to Pennsylvania Avenue as the spiritual center of Washington D.C. It is the hypotenuse of Federal Triangle. The Divine Child is supposed to be the New Age Messiah, the coming together of the cosmic masculine and feminine forces to produce a synergy, which the Masons believe will create the so-called “Perfected Man” who is in fact the Masonic Christ or Antichrist.

The Buchanan monument in Washington D.C. placed Buchanan, a Mason, between a male and female god and goddess as the hypotenuse, where the perfected man is supposed to be. Daniel Carter Beard founded the Boy Scouts of America. The Boy Scout Memorial on 15<sup>th</sup> Street, between East Street and Constitution Ave. show the Boy Scout as the Divine offspring of the male god and female goddess statues he stands between. (Riddles in Stone)

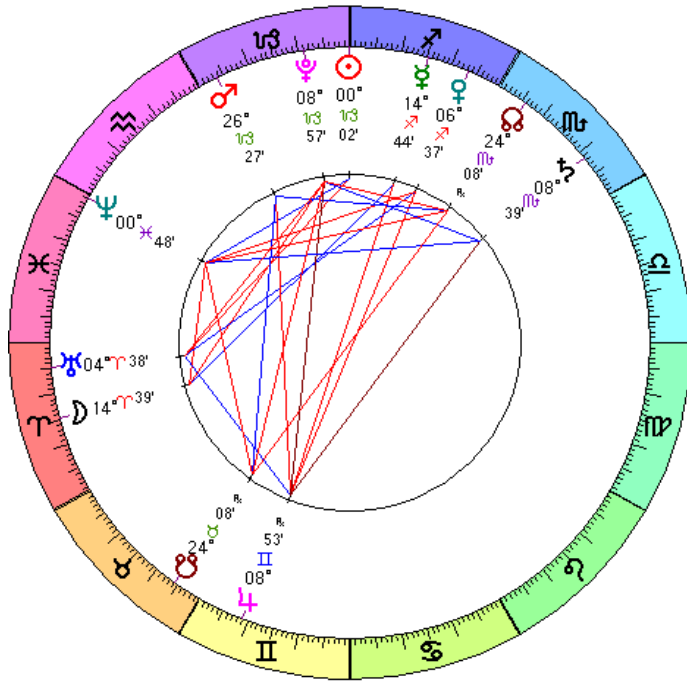

The Mayan calendar above displays a perfected pyramid embodying the Golden Mean formed by Uranus, Jupiter, Saturn and Pluto at the base with an apex forming in Neptune. This pyramid, which perfects on December 21, 2012, heralds the arrival of the Antichrist on the world stage. This will be commemorated in symbolic terms by the capping of the Great Pyramid of Egypt with its missing capstone, an event depicted on the reverse side of the American one dollar bill. This in turn commemorates the ascension of the Masonic Christ or Antichrist to the throne in Jerusalem, an event symbolically conferred by the date December 21, 2001, the chart above confirming this to be the case with the esoteric geometry it invokes.

In addition, a right angle triangle drawing on the energy of Virgo, which is surrounded by a right angle triangle, can also be found in the matrix of lines found in the chart drawing for December 1, 2012, heralding the arrival of the Masons' "Perfected Man," the Masonic Christ or Antichrist. In keeping with the occult belief "As above So Below," a right angle triangle is formed in the chart of the heavens on December 21, 2012, the malefic planets Saturn and Pluto forming the male energy of the upright line, Jupiter and Saturn forming the feminine energy of the base, and Pluto and Jupiter forming the hypotenuse representing the Divine Child, which in this case is the Antichrist.

It turns out that the International Swine Flu Conference August 19-21 Washington D.C. is being held in a place of due ceremony for the occultists. If you reread my article, you will be shocked to discover that the same street in Washington D.C. that they are holding their little Antichrist Swine Flu party – how to take out the goyim by their own unclean habit of eating swine – is the very same street that happens to be the hypotenuse of Federal Triangle, namely Pennsylvania Ave. And let's not forget, to the occultists, the hypotenuse of the right angle triangle represents the so-called "perfected man", the Masonic Christ, the Antichrist. So the swine flu conference in Washington D.C. is a date with the Antichrist. Remember also that the "Sylvania" in Pennsylvania refers to a wooded area or grove of trees where witchcraft rites are held.

Washington D.C. is home to an elaborate street plan, which employs ancient arts, which could be compared with the “strongholds” of the Old Testament described in such books as Exodus, Isaiah, Daniel, etc. The street plan of Washington incorporates the Platonic solids into its elaborate design: Hexahedron (Earth), Octahedron (Air), Tetrahedron (fire), Icosahedron (Water), and Dodecahedron (Ether). The Platonic solids are the basis of all matter. Observation Circle is home to U.S. Naval Observatory and the Vice-president, currently Joe Biden. It represents the Moon Goddess Isis on the Washington street map. Observation Circle is 2160 feet while the moon’s diameter is 2160 miles across. Columbia Circle at Union Station is the sun Circle. The streets of Columbus circle form the sun’s rays of light: Massachusetts Ave., S St, E St., Louisiana Ave., Delaware Ave., 1<sup>st</sup> St., and to Massachusetts Ave. Meridian Hill Park St. Off 16<sup>th</sup> Ave. is located off 16<sup>th</sup> St., which is the meridian line for most of Washington’s sacred geometry. The Octahedron is one of the Platonic solids, symbolizing the air element. There is an Octahedron on 16<sup>th</sup> Ave. The points on the Octahedron are the White House, Logan’s Circle, the apex of the Octahedron (16<sup>th</sup> and U Street) and back to the White House. The Octahedron is symbolic of the union between the spiritual and physical like the 6-pointed star and the yin/yang symbol. They bring together all opposites, the highest attainable for all sorcery.

Tetrahedron is the CITGO Gas Station logo. In Washington, the shape is formed by Washington Circle, Mt. Vernon Square, and the apex at U and 16<sup>th</sup> St. The connecting streets are 16<sup>th</sup> St., K St., New Hampshire Ave, a line between U and 16<sup>th</sup> St. And Mt Vernon Square. The centre of the Tetrahedron is Scott’s Circle, which connects to the apex by 16<sup>th</sup> St., and the White House by Rhode Island Ave. and Mt. Vernon Square, by Massachusetts Ave. This sacred geometry forms a stronghold, empowering the sorcerers to impose their will on the physical plane. They do this by manipulating the element of fire, which is the element housed within the elemental shape. Beneath this Tetrahedron is the White House, the Jefferson Memorial, the U.S. Capitol Building, and the Lincoln Memorial, which forms a cross. The same cross was later mapped inside a 7-sided coffin-shaped configuration. Does this symbol represent the death of Christianity? The Jefferson Spear Stone, which corresponds to the Tree of Life called the *Sephirah Yesod*, which stands for “foundation”, as in the foundation of a stronghold. *Sephirah* means “spheres, “numbers” or “emanations”. The Sephiroth are the numbers 1 through 10 considered in their archetypal sense. Each Sephira is an archetypal idea. Also, the Sephiroth represents emanations of God and describes the process of Creation.

The Icosahedron represents the element water, so in the union of opposites, it represents the opposition of fire. The points for the Icosahedron are Mt. Vernon Sq., Washington Circle and the Jefferson Memorial. The White House is at the centre of the Icosahedron and is connected by the diagonal lines New York Ave. and Pennsylvania Ave. Inside the Icosahedron is a double square divided by 16<sup>th</sup> St. With four triangular areas. These symbols represent the square root of 5. This is the Golden proportion that opens the family relationships, which links the world of matter with the world of spirit. One square is formed from K St., U St., 7<sup>th</sup> St., and 16<sup>th</sup> Ave. Through the centre are P St. 13<sup>th</sup> St. This triangular shape opens the Golden Ratio, which represents Pi, the key to the geometry of the universe.

The Heptagon is a 7-pointed star. The sorcerer Sir John Dee used it in his occult rites as did Aleister Crowley. It is formed in Washington by Logan’s circle, Dupont Circle, Washington Circle, the Lincoln Memorial, the Jefferson Memorial, the Hershen Sculpture Garden, and Mt. Vernon Square. These points correspond with the 7 classical celestial bodies: Jefferson Memorial with the Sun, Lincoln Memorial with Mars, Jupiter with Washington Circle, Dupon Circle with Saturn, Logan Circle with the Moon, Mt. Vernon Sq. with Mercury, and the Hershorn Sculpture

Gallery with Venus. The sculpture at Dupont Circle shows a female figure holding a globe with a ring around the globe. The Jefferson Memorial aligns with the summer solstice via Maryland Ave. The sun would rise over the capitol Dome from this viewing vantage point. It is on a direct line from the Jefferson Memorial along Maryland Ave. to the National Arboretum, where a sacred grove is erected consisting of 22 pillars or columns of stone, which correspond with the 22 major arcana of the Tarot deck and the 22 paths of the Kabbalistic Tree of Life. Within the Heptagon is a five-pointed star called a Hexagram. The points of the Pentagram are the White House, Mt. Vernon Sq., Washington Circle, Logan Circle, and Dupont Circle. The pentacle star also represents Venus because of her 5-pointed transit points in her 8-year cycle. It is also employed as the sign for Virgo and the sign for Isis. There is also a Hexagram with the Heptagon formed of Logan Circle, Dupont Circle, Washington Circle, Mt. Vernon Sq., Freedom Plaza, Rawlings Park. It is used in ritual magic for evoking and banishing spirits. The Heptagon is not a platonic solid. It is a seven-sided star used in sorcery.

The Kabbalistic Tree of Life is formed of 3 pillars, 10 worlds and 22 paths. The 3 pillars are connected to the 10 worlds by the 22 paths. There is the Pillar of Severity, the Pillar of Mercy, and the Pillar of Mildness. These 3 pillars can be related to the 3 central channels of energy in yoga, the Pengala, the Shashumna, and the Ida, which are linked to the seven chakra points and other meridian points within the body. The 10 worlds are Crown (crown chakra), 2 wisdom, 3 understanding, 4 mercy 5 severity, 6 beauty, 7 victory, 8 glory, 9 foundation, 10 kingdom, and an optional 11<sup>th</sup> world referred to as knowledge.

Hegel's dialectic can be seen as the 3 pillars of the Tree of Life. The thesis represents the Pillar of Severity, the Antithesis the Pillar of Mercy, leading to the Pillar of Mildness, which is madness. This corresponds with problem-reaction-solution. The Kabbalistic Tree of Life is laid out on the Washington street plan with the Crown at U and 16<sup>th</sup> St., Wisdom at Logan Circle, 3 Understanding at Dupont Circle, 4 Mercy at 13<sup>th</sup> St., and New York Ave., 5 Severity 19<sup>th</sup> St. And Pennsylvania Ave., 6 the White House Kabbalistic point Beauty, 7 Victory at Freedom Plaza, 8 Glory at Rawlings Park, 9 Foundation at Jefferson Peer Stone, and Jefferson Memorial the Kabbalistic point Kingdom. An optional Kabbalistic point 11 is Scott's Circle, which is knowledge. The Pillar of Severity is found at 19<sup>th</sup> St. Between Dupont Circle and E St., Pillar of Mercy at 13<sup>th</sup> St. Between Logan circle and E St. And Pillar of Mildness at 16<sup>th</sup> St. Between U St. and Jefferson Memorial.

The Great Pyramid in Washington is located at the first point at Independence Ave. and 1<sup>st</sup> St., where the Cannon House Building is located, draw a straight line across Independence Ave. to Arlington Cemetery, forming the foundation of the Great Pyramid. Going back to Independence Ave. and 1<sup>st</sup> St., a straight line is drawn through the Capitol Dome, Logan Circle to the apex of the pyramid found at U St. and 16<sup>th</sup> Ave. Then from the apex, a line is drawn along New Hampshire Ave. through Logan Circle, Washington Circle to Arlington National Cemetery. The passage system of the Great Pyramid is also laid out in the street plan of Washington. The descending passage or well shaft is Maryland Ave. starting at the U.S. Capitol Building and ends at the Jefferson Memorial, which corresponds with the subterranean chamber of the Great Pyramid. The ascending passageway leading to the grand Gallery of the Great Pyramid is Pennsylvania Ave. ending at Freedom Plaza, the Queen's Chamber passageway is Constitution Ave. The area between the ascending passage (Pennsylvania Ave.) and the Queen's chamber passageway (Constitution Ave.) is Federal Triangle. The ceiling and the relieving stones in the King's chamber of the Great Pyramid are composed of I St, K, St, L St, De Salle's St, and M St. The ceiling of the King's chamber forms into a pointed roof with Rhode Island Ave. between



Connecticut Ave. and Scott Circle and Massachusetts Ave. between Scott Circle and Thomas Circle. The sides of the chamber are framed by 17<sup>th</sup> St., 15<sup>th</sup> St., and the meridian of the pyramid drawn through the apex of the King's Chamber ceiling down to the subterranean chamber formed by the Jefferson Memorial up to the apex of the Great Pyramid, which is formed by 16<sup>th</sup> Ave, which passes through the Meridian Hill Park. Within this sacred geometry is Station Stone rectangle also found at Stonehenge formed from K St. between Washington Circle and the 13<sup>th</sup> St., 13<sup>th</sup> St. between K St. and Logan Circle, P St. between Logan Circle and 23<sup>rd</sup> St., and 23<sup>rd</sup> St. P St. and Washington Circle. The perimeter of Station Stone Rectangle in Washington corresponds with the length of one side of the Great Pyramid at Giza, the perimeter also equals the foundation line of the Great Pyramid formed in the street plan of Washington. The Nile River in Egypt forms a delta branching to the left and to the right. The Potomac River also branches to the left and to the right.

The Golden Rectangle is formed at 1<sup>st</sup> St. between Independence Ave. and P St., and Independence Ave. and Independence Ave. between Potomac St. and 1<sup>st</sup> St. with the Eye of the Golden Triangle being Washington Circle. The lines within the Golden Triangle form a diagonal line along Pennsylvania Ave. between the Capitol Building and Potomac St. and a second line is formed from Pennsylvania Ave. and 1<sup>st</sup> St. to Logan Circle, and a third line formed by 19<sup>th</sup> St. between Dupont Circle and Independence Ave., a fourth line by New Hampshire Ave. between Dupont Circle and Arlington National Cemetery, a fifth at I St. between Pennsylvania Ave. and the perimeter line of Potomac St., a sixth formed at 25<sup>th</sup> St., between New Hampshire Ave. and P St., a seventh at 23<sup>rd</sup> St. between 1<sup>st</sup> St. and L St., an eighth at L St. between 25<sup>th</sup> St. and 19<sup>th</sup> St.. and ninth at K St. between 25<sup>th</sup> St. and 19<sup>th</sup> St.

There is also a Golden Rectangle encoded in the American one dollar bill. The dollar bill was designed by Edwin Mitchell Weeks. It was discovered by NASA through the Wilconsin microwave probe that the universe was in the shape of a dodecahedron, which represents ether which is the energy of the universe, and within every dodecahedron is a Golden Rectangle. It is self-evident that the Black Magicians are trying to draw this ether energy from the universe through the Golden Rectangle found in the Washington street plan and the one in the U.S. dollar bill. It is a cabbalistic microcosm of the macrocosm. There is a Golden Rectangle in the Holy Land formed in the birthplace of the Lord Jesus in Bethlehem, which is at 31.68° N., which forms a Golden Rectangle based on the polar and equatorial diameters of the Earth. The key to this energetic template of the Golden Rectangle is Phi 1.618. Phi is encoded in the Eastern Star Lodge on New Hampshire Ave. New Hampshire Ave. connects the Eastern Star Lodge to Washington Circle, the Eye of the Golden Rectangle in the nation's capital. The Eastern Star Lodge address is 1618 New Hampshire Ave., which is Phi.

The relationship between an icosahedron and a dodecahedron creates an inter-dimensional geometric figure and is also found in the center of Washington. This is a 3-D shape on a 2-D plane. It is formed by Jefferson Monument, the Lincoln Memorial. Washington Circle, Dupont Circle, the apex U St. and 16<sup>th</sup> Ave. and Logan Circle, Mt. Vernon Square. Merchuan Sculpture Garden, the White House and Scott Circle, formed by 23<sup>rd</sup> St. between Lincoln Memorial and Washington Circle, New Hampshire Ave. between Washington Circle and U St., a line between U St. and Mt. Vernon Sq., 8<sup>th</sup> St. between Mt. Vernon Sq. and Herchem Sculpture Garden, Pennsylvania Ave. between Washington Monument and the White House, New York Ave. between the White House and Mt. Vernon Square., Massachusetts Ave. between Mt. Vernon Sq. and Scott's Circle, Rhode Island Ave. between Scott's Circle and Washington Circle, 16<sup>th</sup> Ave. between U St. and the Jefferson Memorial, a line between the Jefferson Memorial and Hershel

Sculpture Garden, a line between the Jefferson Memorial and the Lincoln Memorial. This is connected with the geometry of the apex of the Washington Monument and the Beckers-Hayden Planetary Grid of 1983. The law of similar comes into play here, the microcosm in harmony with the macrocosm. The interplay between the icosahedrons and the dodecahedron is expressed in Washington in  $1/20^{\text{th}}$  of the icosahedron face and the dodecahedron face, where  $1/12^{\text{th}}$  of the face is seen in the Pentagon Building. These shapes tap into the resonance frequency of the planet.

Vesica Pisces is the archetypal expression of twoness. It expresses growth by division and is expressed in the layout of the nation's capital. The two interlocking circles have an intersection point considered a portal between the physical and spiritual planes. The Vesica Pisces is in Washington. The dimensions of the Great Pyramid relate to the Vesica Pisces as do the dimensions of the pyramid in Washington. In the occult world, the Vesica Pisces is related to the pineal gland. The pineal gland is the Third Eye, which allows for direct communication with great spiritual beings. The astrophysicist Carl Schwarzschild showed a wormhole featuring the Vesica Pisces. The Washington Monument is located in the center of 2 interlocking circles at the center of the Vesica Pisces. The oval office in Washington is based on the Vesica Pisces and amplifies the biophysical energies of the human body. It is part of the greater whole of the interlocking circles, which form the flower of life. The flower of life allows for the formation of all the Platonic solids.

In the middle of the line where the M cuts the lesser line, the consort stone is found in Washington at Kentucky Ave. between Lincoln Park and Burney Circle, Tennessee Ave. between Lincoln Park and Maryland Ave., Pennsylvania Ave. between the Capitol Dome and Burney Circle and Maryland Ave. between Capitol Dome and where it intersects Tennessee Ave. At the National Shrine in Washington, there is a dedication to the Virgin Mary. It features an M with a horizontal line stretched between it, surmounted by a cross formed by Massachusetts Ave. between Lincoln Park and 15<sup>th</sup> St., South Carolina Ave. between south and 15<sup>th</sup> St., 14<sup>th</sup> St. between South C St. and North C St. East Capital is the street of demarcation between North Washington and South Washington, North Carolina Ave. between Lincoln Park and 14<sup>th</sup> St. and 19<sup>th</sup> St. The south side of the horizontal cross is formed by 18<sup>th</sup> St. between Independence Ave. and east Capital St. The north side is missing. That is where the treasure is likely located. The next clue is in the National Gallery of Art. It is the painting "Sacrament of the Last Supper by Salvador Dali. The painting forms a pyramid with the apex on the Adam's apple of the floating figure. Who is the figure supposed to represent? Is this revelation by omission perhaps? Potomac River and Potomac Ave. are significant. "Potomac" means something brought or the place where something is brought" in the Algonquin language. An area east of Lincoln Park is where the treasure was brought, Eastern High School on East Capitol St., which is the demarcation street between the lettered streets in north Washington and North B St. or South B St. and South A St. There is north B St. or South B St. There are other letters to J, but no North J St. or South J St. There is a coffer in a Templar shrine in France. It is a clue to the city where the treasure is hidden, Washington. The missing head of the figure is that of John the Baptist. The treasure is the head of John the Baptist, which gives the city spiritual power to draw from.

The National Mall harnesses energies from popular demonstrations and also from cemeteries like Arlington National Cemetery, Congressional Cemetery and Fort Lincoln Cemetery in Maryland. In Congressional Cemetery, the spiritual energy is harnessed from the 166 cenotaphs, meaning "empty tomb", monuments to the dead whose remains may be buried elsewhere. It represents the handle of the sword with the blade stuck in the ground to collect energy. Spiritual energies are being harnessed in Arlington Cemetery from the JFK Memorial and the Lincoln

Memorial. The assassinated presidents are linked in death by the Arlington Memorial Bridge. They were linked in life by the law of similars. They are linked in death through Washington Circle via 23<sup>rd</sup> Ave. and the Arlington Memorial Bridge and Washington Circle is the Eye of the Golden Rectangle. The Eye of the Circle of the Lincoln Memorial connects with the future, the Lincoln assassination with the future Kennedy assassination.

*Qi* or *prana* chakras in Washington correspond with body chakras and meridians. 16<sup>th</sup> St. represent the *Shushumna*. There are 7 chakra points: Jefferson Memorial (the root chakra), Jefferson Peer Stone (the sex chakra), the Zero Mile Marker (the navel chakra), the White House (the heart chakra), Lafayette Park (the throat chakra), Scott's Circle (the brow chakra), U st. and 16<sup>th</sup> St. (the Crown Chakra), the apex of the Great Pyramid.

Check Isaiah 10. Our deliverance is like exodus and the story of Gideon Judges 6. There are 29 stone obelisks from Egypt that have been moved to key positions around the world. It means "veil shaft" obelisk. Washington Monument is really a pyramid lifted up or exalted. Judges 6 describes the tearing down of the veil of Asherah, which is the obelisk. The Ashera is the Pentagon. Check out Corinthians 2:6. Daniel 9 is about the power of praying a prophecy. Praying for the end of sorcery can impede the black magicians from harnessing the power of their strongholds. Isaiah 52 is about awakening and coming out of the spell and overcoming the "world" through faith. The only ones to do it are the "remnant" that is part of the body of Christ, as Leviticus 26:6-8 contends: "But you will chase your enemies, and they will fall before you by the sword; five of you will chase a hundred, and a hundred will chase ten thousand, and your enemies will fall before you by the sword."

("DC Street Sorcery", <http://archives.sfaw.org/video-03-2009.asp>)